

Connect Using WPA2-Enterprise in Apple IOS

1. From your home screen select “settings.”

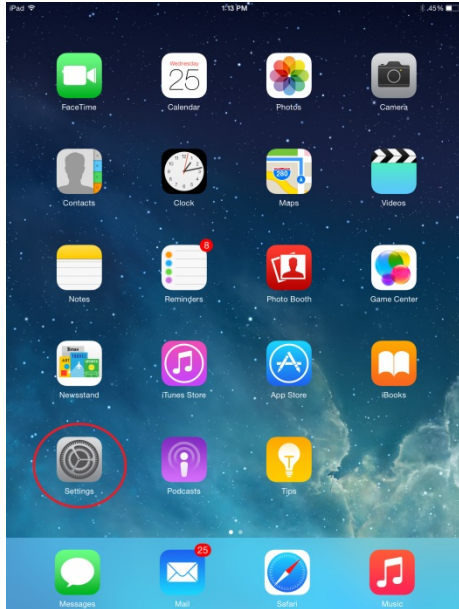

2. On the left select “Wi-Fi” and on the right select “MGANet-Secure”. If you are in the dorms, you must select “ResNet-Secure.”

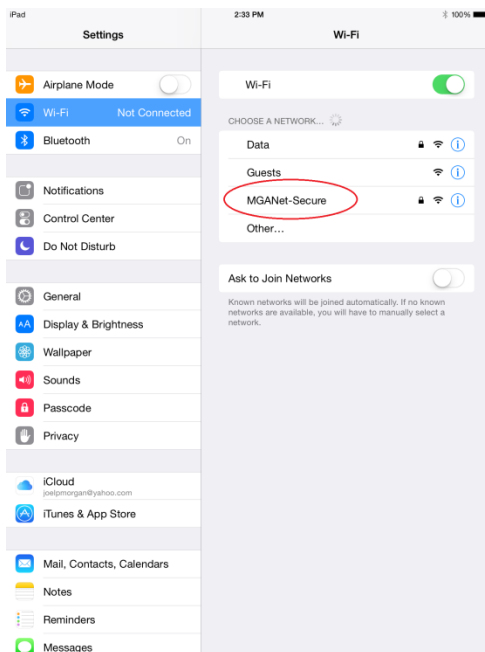

3. Enter your MGA email address and password.

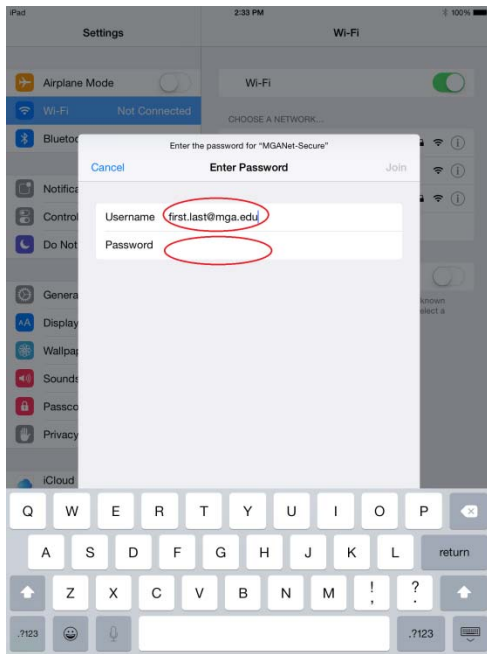

4. Click "Trust" or in some cases "Accept" to trust the DigiCert Global Root certificate

